

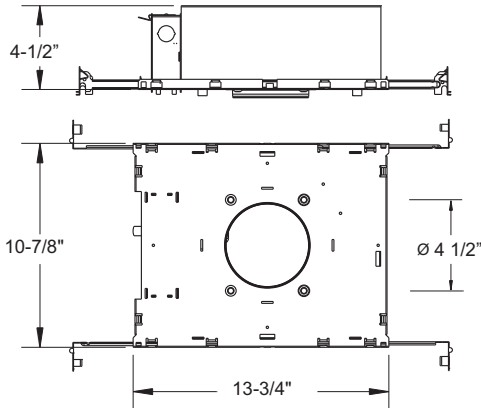

2-060-F-C/P-GX10-CMH

GX10-CMH Non I/C Housing

SPECIFICATIONS

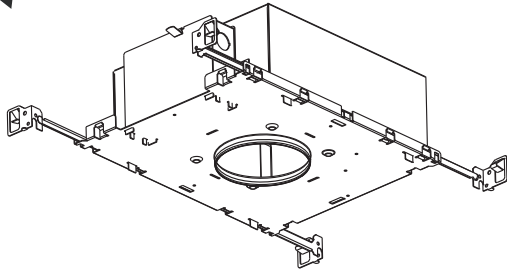

Housing:

- Rated Non I/C for Chicago Plenum Installations.
- Unique design allows for installation in shallow plenums as low as 5"
- Black powder coated 20ga. C.R.S. baseplate designed for bi-directional mounting of hanger bars.
- 16" Hanger bars supplied as standard

J-box:

- 18ga galvanized steel
- 5 K.O. around j-box to allow for easy wire entry
- Approved for through wiring applications.

Thermal Protection:

- All housings have overload protection for over lamping.

Ballast:

- 20W or 39W Electronic HID integrally mounted in housing
- Available for 120V or 277v operation
- Ballast is accessed through ceiling opening

Socket:

- Socket type GX10 (lamp by others)

Maximum Wattage:

- Housing is rated to 20W or 39W Maximum (Ballast must be specified)

Chicago Plenum:

- CCEA approved (City of Chicago Environmental Air) meeting section 18-27-300.22© of the City of Chicago Electrical Code.

Guarantee:

- 5 Year Warranty

ORDER GUIDE

| HOUSING | WATTAGE | VOLTAGE | OPTION |
|-------------|--------------|---------|---|
| 2-060-F-C/P | 20W GX10-CMH | 120 | BPHI - (Black Painted Housing Interior) |
| | 39W GX10-CMH | 277 | WPHI - (White Painted Housing Interior) |

Trims to be used with 2-060-F-C/P-GX10-CMH High Wattage Frame - In Kit

| | |
|------------------------|----------------------|
| Aqua | Lensed Picolo |
| Aurora | Picolo |
| Deep Aurora | Pin Hole |
| Coral | Pivot |
| Conus | Siris |
| Demi | Star Lite |
| Eclipse | Sunburst |
| Flare Wall Wash | Slice |
| Key Hole | |

See individual specification sheets for trim details

DaSal Industries Ltd.
 Unit #804-1515 Broadway Street
 Port Coquitlam, BC V3C 6M2
 Phone (604) 464-5644 Fax (604) 464-0888
 www.dasalindustries.com

Data and specifications subject to change without notice

| | |
|------|--------------|
| Type | Project Name |
| | Order Number |

