

MAX 2 TITANIUM

INDOOR (MR16 LOW VOLTAGE HALOGEN LAMPS)

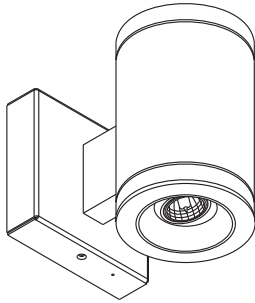

SPECIFICATIONS

- MAX 2 MR16 Titanium is a wall mounted architectural low voltage cylinder designed to incorporate a large selection of DaSal architectural trims.
- MAX 1 Titanium cylinder is damp location listed.
- The Titanium cylinder collection is manufactured of 6061 extruded aluminum alloy.
- All hardware supplied is made of stainless steel.
- Rated for 2x75 Watt MR16 lamp (UP/Down version).
- MAX 1 MR16 Titanium is powered by electronic transformer and is fully dimmable.
- Any trim selected are designed to use a wide range of specialty lenses.
- 5 year warranty

Applications: bars, pubs, retail spaces, lobbies, conference rooms, offices, and is ideal for dimming applications.

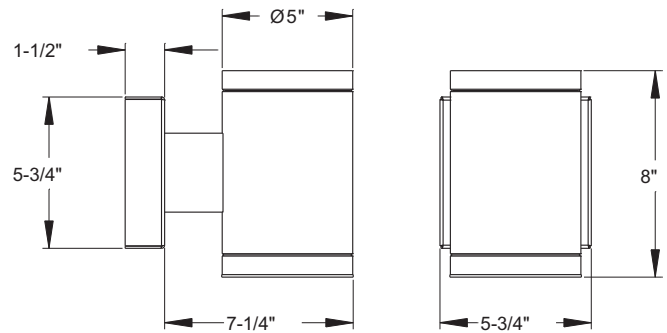

ORDER GUIDE

SERIES	TRIM TYPE ¹	VOLTAGE	FINISH	OPTION
MAX2 Wall Mount	2-120 - Aurora	120	01 - White	D - Down Light
	2-140 - Eclipse	277	04 - Black	U/D - Up/Down Light
	2-150 - Siris		05- Matte Silver	
	2-160 - Demi		11 - Matte Nickel	
	2-165 - Star Life		CC- Custom	
	2-170 - Conus			
	2-180 - Pin Hole			
	2-182 - Flare Wall Wash			
	2-185 - Picolo			
	2-187 - Lensed Picolo			
	2-190 - Key Hole			
	2-195 - Pivot			
	2-200 - Split			

Note:
1) Must use Trim specification sheets for specifying complete trim part numbers

DaSal Industries Ltd.
Unit #804-1515 Broadway Street
Port Coquitlam, BC V3C 6M2
Phone (604) 464-5644 Fax (604) 464-0888
www.dasalindustries.com

Data and specifications subject to change without notice

Type	Project Name
	Order Number

