

## MAX 3 TITANIUM

INDOOR (MR16 LOW VOLTAGE LAMPS)

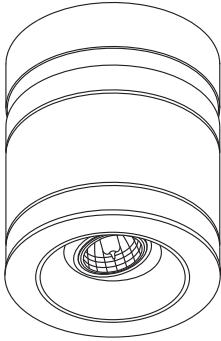

### SPECIFICATIONS

- MAX 3 MR16 Titanium is a surface mount architectural low voltage cylinder designed to incorporate a large selection of DaSal architectural trims.
- The Titanium cylinder collection is manufactured of 6061 extruded aluminum alloy.
- Rated for 75 Watt MR16 lamp.
- MAX 3 MR16 Titanium is powered by electronic transformer and is fully dimmable.
- Any trim selected is designed to use a wide range of specialty lenses.
- Very shallow design available (requires flat canopy option)
- MAX 3 Titanium cylinder is damp location listed.
- 5 year warranty

Applications: any surface mount interior applications such as elevator lobbies, vestibules, soffits and entrances to commercial buildings. This product is ideal for dimming applications.

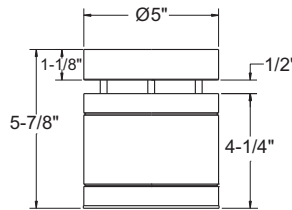

Standard canopy

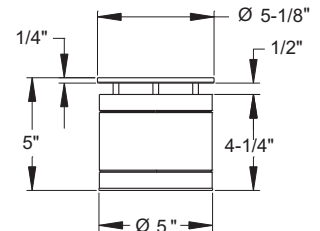

Flat canopy option

### ORDER GUIDE

SERIES	TRIM TYPE <sup>1</sup>	VOLTAGE	FINISH	OPTION
MAX3 Surface Mount	2-120 - Aurora	120	01 - White	FC - Flat Canopy
	2-140 - Eclipse	277	04 - Black	
	2-150 - Siris		05- Matte Silver	
	2-160 - Demi		11 - Matte Nickel	
	2-165 - Star Life		CC- Custom	
	2-170 - Conus			
	2-180 - Pin Hole			
	2-182 - Flare Wall Wash			
	2-185 - Picolo			
	2-187 - Lensed Picolo			
	2-190 - Key Hole			
	2-195 - Pivot			
	2-200 - Split			

Note:  
1) Must use Trim specification sheets for specifying complete trim part numbers

DaSal Industries Ltd.  
Unit #804-1515 Broadway Street  
Port Coquitlam, BC V3C 6M2  
Phone (604) 464-5644 Fax (604) 464-0888  
www.dasalindustries.com

Data and specifications subject to change without notice

Type	Project Name
	Order Number

